

RUNWAY DATA	EXISTING				ULTIMATE			
	3	21	13	31	3	21	13	31
RUNWAY LENGTH	4000 FT		5000 FT		SAME		SAME	
RUNWAY WIDTH	100 FT		100 FT		SAME		SAME	
RUNWAY AIRCRAFT REFERENCE CODE	B-II		C-II		SAME		SAME	
RUNWAY APPROACH TYPES	VISUAL		PRECISION NON-PRECISION		SAME		SAME VISUAL	
RUNWAY APPROACH SURFACE SLOPE	20:1	20:1	34:1	10,000 29.5:1 40,000	34:1	SAME		20:1
RUNWAY THRESHOLD DISPLACEMENT	N/A		N/A		SAME		SAME	
RUNWAY SAFETY AREA*	150 FT X 4,600 FT		400 FT X 6,800 FT		SAME		SAME	
RUNWAY OBJECT FREE AREA	500 FT X 4,600 FT		800 FT X 6,600 FT		SAME		SAME	
RUNWAY SURFACE MATERIAL	ASPHALT		ASPHALT		SAME		SAME	
PAVEMENT STRENGTH	S=30,000 D=44,000		S=30,000 D=44,000		SAME		SAME	
RUNWAY EFFECTIVE GRADIENT	0.013		0.024		SAME		SAME	
RUNWAY MARKING	NON-PRECISION	NON-PRECISION	PRECISION	PRECISION	SAME		SAME VISUAL	
RUNWAY APPROACH LIGHTING	REILs, VASI 4-L	NONE	MALSR	REILs	SAME		SAME	
RUNWAY EDGE LIGHTING	MIRLs		HIRLs		SAME		SAME	
RUNWAY NAVIGATIONAL AIDS	NONE	NONE	ILS	GPS	SAME		SAME	
TAXIWAY EDGE LIGHTING	TAXIWAYS 'A' - MITLs		TAXIWAY 'B' - MITLs		MITLs			
TAXIWAY MARKING	TAXIWAYS 'A' & 'B'-C AND EDGE STRIPING, HOLD LINES				CENTER LINE AND EDGE STRIPING, HOLD LINES			
TAXIWAY OBJECT FREE AREA WIDTH	131 FT	131 FT	131 FT	131 FT	SAME			

\* PAVEMENT STRENGTHS ARE EXPRESSED IN SINGLE (S), DUAL (D) AND DUAL TANDEM (DT) WHEEL LOADING CAPACITIES.  
 \*\* ONLY THE EXISTING AVAILABLE RSA HAS BEEN IDENTIFIED. DISTANCE BEYOND THE USABLE PAVEMENT IS SHOWN IN THE RUNWAY TABLE.

NONCONFORMING CONDITIONS				
DESCRIPTION	STANDARD	EXISTING/PLANNED	REMARKS	DATE APPROVED
RUNWAY SAFETY AREA ONLY EXTENDS 800' BEYOND RUNWAY 31	1000' BEYOND RUNWAY END	800'/800'	THIS MODIFICATION WAS PREVIOUSLY ACCEPTED BY THE FAA IN 1997.	PENDING
RUNWAY OBJECT FREE AREA ONLY EXTENDS 600' BEYOND RUNWAY 31	1000' BEYOND RUNWAY END	600'/600'	THIS MODIFICATION WAS PREVIOUSLY ACCEPTED BY THE FAA IN 1997.	PENDING

CERTIFICATION:  
 I HEREBY CERTIFY THAT ALL AIRPORT ELEMENTS SHOWN ON THIS ALP ARE IN ACCORDANCE WITH CRITERIA CONTAINED IN THE CURRENT EDITION OF FAA ADVISORY CIRCULAR 150/5300 13 EXCEPT AS NOTED IN THE TABLE ENTITLED "NONCONFORMING CONDITIONS".

NAME \_\_\_\_\_ DATE \_\_\_\_\_  
 PRINTED NAME/TITLE \_\_\_\_\_

RUNWAY END DATA		
RUNWAY	LAT.	LONG.
3	44° 03' 21.59"	69° 06' 02.68"
21	44° 04' 00.04"	69° 05' 49.97"
13	44° 03' 41.45"	69° 06' 30.04"
31	44° 03' 23.81"	69° 05' 26.08"

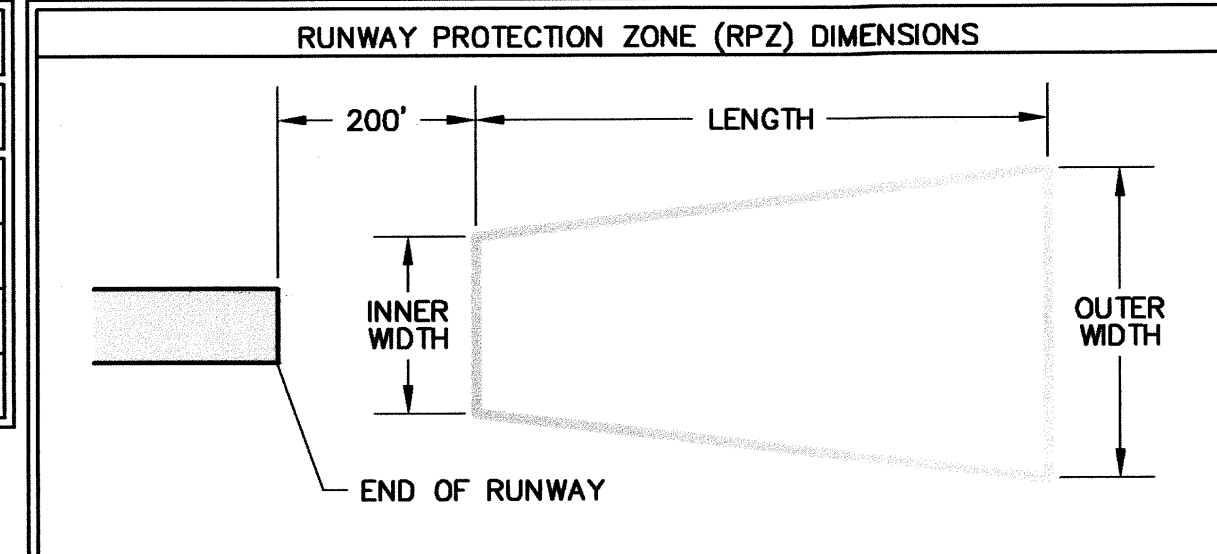

EXISTING AND ULTIMATE					
RUNWAY	APPROACH TYPE	INNER WIDTH	OUTER WIDTH	LENGTH	ACRES
R/W 3	VISUAL	500'	700'	1,000'	13.77
R/W 21	VISUAL	500'	700'	1,000'	13.77
R/W 13	VISIBILITY LESS THAN 3/4 MILE	1000'	1750'	2,500'	78.91
R/W 31	VISUAL	500'	1,010'	1,700'	29.46

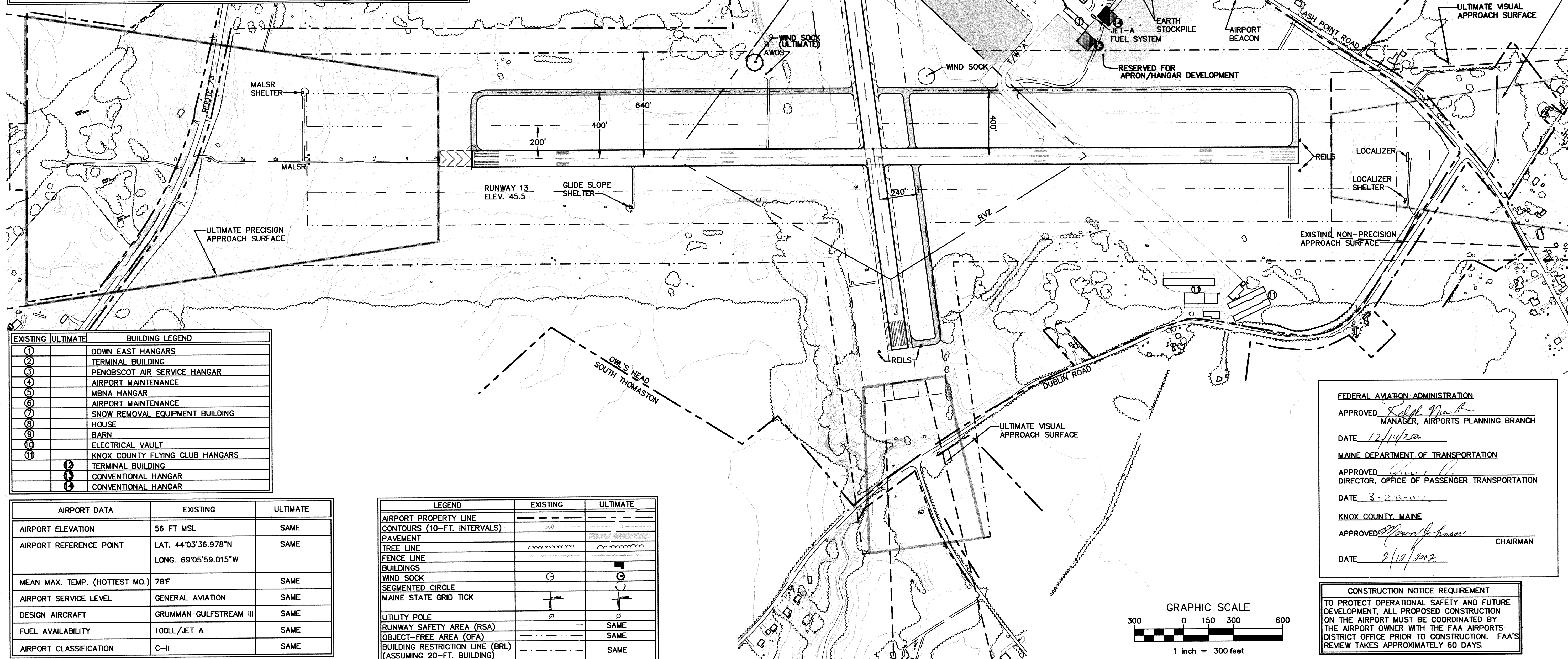

APR 02 2002

EXISTING	ULTIMATE	BUILDING LEGEND
1		DOWN EAST HANGARS
2		TERMINAL BUILDING
3		PENOBSCOT AIR SERVICE HANGAR
4		AIRPORT MAINTENANCE
5		MBNA HANGAR
6		AIRPORT MAINTENANCE
7		SNOW REMOVAL EQUIPMENT BUILDING
8		HOUSE
9		BARN
10		ELECTRICAL VAULT
11		KNOX COUNTY FLYING CLUB HANGARS
12	12	TERMINAL BUILDING
13	13	CONVENTIONAL HANGAR
14	14	CONVENTIONAL HANGAR

AIRPORT DATA	EXISTING	ULTIMATE
AIRPORT ELEVATION	56 FT MSL	SAME
AIRPORT REFERENCE POINT	LAT. 44°03'36.978"N LONG. 69°05'59.015"W	SAME
MEAN MAX. TEMP. (HOTTEST MO.)	78°F	SAME
AIRPORT SERVICE LEVEL	GENERAL AVIATION	SAME
DESIGN AIRCRAFT	GRUMMAN GULFSTREAM III	SAME
FUEL AVAILABILITY	100LL/JET A	SAME
AIRPORT CLASSIFICATION	C-II	SAME

LEGEND	EXISTING	ULTIMATE
AIRPORT PROPERTY LINE	---	---
CONTOURS (10-FT. INTERVALS)	---	---
PAVEMENT	---	---
TREE LINE	---	---
FENCE LINE	---	---
BUILDINGS	○	○
WIND SOCK	○	○
SEGMENTED CIRCLE	○	○
MAINE STATE GRID TICK	+	+
UTILITY POLE	⊥	⊥
RUNWAY SAFETY AREA (RSA)	---	SAME
OBJECT-FREE AREA (OFA)	---	SAME
BUILDING RESTRICTION LINE (BRL) (ASSUMING 20-FT. BUILDING)	---	SAME

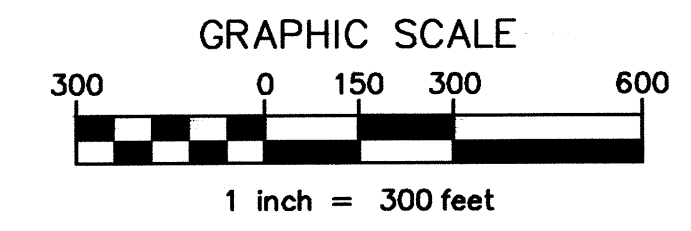

FEDERAL AVIATION ADMINISTRATION  
 APPROVED *Sally M. ...*  
 MANAGER, AIRPORTS PLANNING BRANCH  
 DATE 12/14/2001

MAINE DEPARTMENT OF TRANSPORTATION  
 APPROVED *James ...*  
 DIRECTOR, OFFICE OF PASSENGER TRANSPORTATION  
 DATE 3-2-02

KNOX COUNTY, MAINE  
 APPROVED *Mark ...*  
 CHAIRMAN  
 DATE 2/12/2002

CONSTRUCTION NOTICE REQUIREMENT  
 TO PROTECT OPERATIONAL SAFETY AND FUTURE DEVELOPMENT, ALL PROPOSED CONSTRUCTION ON THE AIRPORT MUST BE COORDINATED BY THE AIRPORT OWNER WITH THE FAA AIRPORTS DISTRICT OFFICE PRIOR TO CONSTRUCTION. FAA'S REVIEW TAKES APPROXIMATELY 60 DAYS.

**Dufresne-Henry Consulting Engineers**  
 Portland, ME 04101  
 Tel: (207) 775-3211 • Fax: (207) 775-6434 • www.d-h-inc.com

KNOX COUNTY REGIONAL AIRPORT  
 A.I.P. NO. 3-23-0042-1087

**AIRPORT LAYOUT PLAN**

Project No. 816034-01  
 MBS  
 JEG  
 MRS  
 JEG  
 AS NOTED  
 DGD  
 489

Sheet 3 of 11